

Fig 0488 - Air-Fuel Separator

CONSTRUCTION:

- Black Polymer
- Air Fuel (A/F) separators are designed to protect canisters from liquid fuel. Vapors pass through the device to the canister while liquids are returned to the fuel tank.
- Perko A/F separators mount using the same “floating bracket” system used on Perko/Delphi carbon canisters.
- A 0588 series TVV is mounted inside each Perko A/F separator giving it slosh protection and the restriction needed to aid in automatic pump shutoff.
- Available with heat shields for use in engine compartment installations.
- Properly installed, A/F separators can replace tank vent valves, eliminating the need to provide access to distant parts of the fuel tank.

5



A/F Separator
Cutaway View



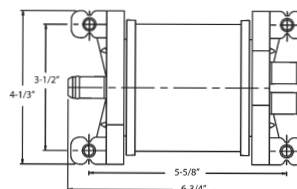
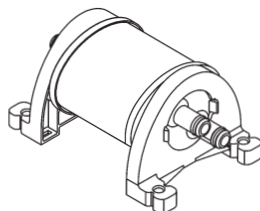
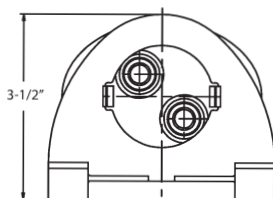
Fig. 0488001



Vent Valve

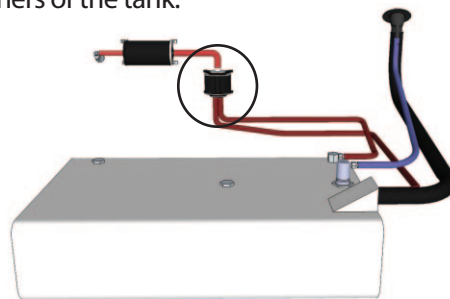


Fig. 0488H01
with Heat Shield



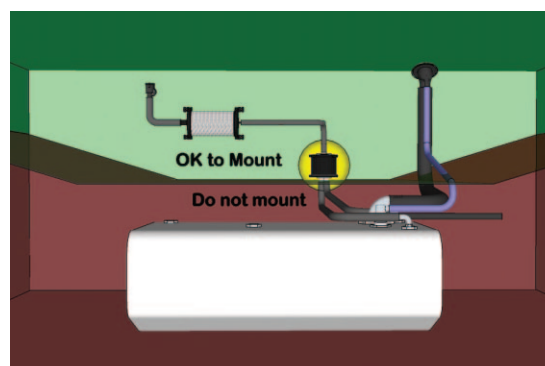
Air-Fuel Separator Access Issues

Perko's Air Fuel Separator helps solve difficult access problems. Running internal vent lines (in either plastic or aluminum tanks) and replacing the tank vent valves with an air fuel separator eliminates the need to provide access to distant corners of the tank.



Air-Fuel Separator Positioning

Perko's Air Fuel separator must be positioned horizontally above the highest level that fuel in the tank can reach during full tilt or storage. The further away from the port/starboard centerline of the tank that the air fuel separator is located, the higher it must be positioned above the tank.



Ordering Information

Catalog No.	Heat Shield	Length Inches	Width Inches	Projection Inches	Hose Connection Inches	OEM Bulk Pkg.	Shipping Weight Lbs.
0488001	No	6-3/4	4-1/3	3-1/2	5/8	5	3.7
0488H01	Yes	6-3/4	4-1/3	3-1/2	5/8	5	3.7



Fig. 0631 P-Trap with Pressure and Vacuum Relief

CONSTRUCTION:

- Blue polymer body and black splash guard, stainless steel escutcheons and aluminum shaft
- EPA certified pressure relief
- Allows vapor to vent from tank during thermal expansion of fuel and while refueling
- Allows fresh airflow into the tank during thermal contraction of fuel and when engine is running
- Helps to protect canister and fuel system from water
- Splash guard style vent opening reduces water volume entering assembly
- Internal P-Trap design helps to prevent water entering into fuel system
- 90° hose connection (to vent axis)



Fig. 0631

5

Ordering Information

Catalog Number	Vacuum Pressure Relief	Body Color	Splash Guard Color	Hose Size	Hull Thickness	OEM Bulk Pkg. Qty.	Shipping Wt. Carton Lbs.
0631004BLU	Yes	Blue	Black	5/8"	0" to 1"	25	10.1

Figs. 0630 & 0632 P-Traps

CONSTRUCTION:

- Black polymer body with either black or white polymer splash guard
- Allows vapor to vent from tank during thermal expansion of fuel and while refueling
- Allows fresh airflow into the tank during thermal contraction of fuel and when engine is running
- Helps to protect canister and fuel system from water
- Deflector style vent opening reduces water volume entering assembly
- Internal P-Trap design helps to prevent water entering into fuel system
- 90° hose connection (to vent axis)

Fig. 0630 Features: Stainless steel escutcheons, aluminum shaft, and polymer body & splash guard with 5/8" vent line hose connection

Fig. 0632 Features: Multiple styles of splash guards, connection options to fit 5/16" or 5/8" vent line hoses - 5/8" vent line option provides sufficient airflow for refueling vapors

Fig. 0630



Fig. 0632
Shown: Style 1
for 5/8" vent hose



Fig. 0632
Shown: Style 1
for 5/16" vent hose



Fig. 0632
Shown: Style 2
for 5/16" vent hose



Fig. 0632
Shown: Style 2
for 5/8" vent hose



Ordering Information

Catalog Number	Vent Line Hose Size	Splash Guard Style	Splash Guard Color	Max. Hull Thickness Inches	OEM Bulk Pkg. Qty.	Shipping Weight Carton Lbs.
0630004BLK	5/8	Cup	Black	0 to 1	25	10.1
0630004WHT	5/8	Cup	White	0 to 1	10	5.4
0632011BLK	5/16	Style 1	Black	5/8	25	5.0
0632011WHT	5/16	Style 1	White	5/8	25	5.0
0632014BLK	5/8	Style 1	Black	5/8	25	5.0
0632014WHT	5/8	Style 1	White	5/8	25	5.0
0632021BLK	5/16	Style 2	Black	5/8	25	5.0
0632021WHT	5/16	Style 2	White	5/8	25	5.0
0632024BLK	5/8	Style 2	Black	5/8	25	5.0
0632024WHT	5/8	Style 2	White	5/8	25	5.0



Style 1 Mounted



Style 2 Mounted

P-TRAP SPARE PARTS ORDERING INFORMATION

Fig 0630 & 0631 Spare Cap Assembly (includes flange, guard and screw): Black - Cat. No. 063000499B, White - Cat. No. 063000499W
Test Plug Fig. 0630TSTPLG

Fig 0632 Spare Splash Guards:

Style 1: Black - Cat. No. 0592B1099A, White - Cat. No. 0592W1099A, Style 2: Black - Cat. No. 0592B2099A, White - Cat. No. 0592W2099A.